



SAN JOAQUIN WILDLIFE RESCUE CENTER

P.O. BOX 778 (209) 723-9283 Phone & Fax
MERCED, CALIFORNIA 95341 raptorctr@bigvalley.net E-mail

Henkle Barn Owl Nest and House Box Plans
Designed by R. Henkle 1998

The Henkle Barn Owl Box was constructed to offer quality alternative housing. To achieve owl acceptance of this house it must provide the maximum advantage for safety, shelter and mobility to the barn owl family. The utmost importance of this design is given to ventilation, height positioning and durability.

Owls are sensitive to the needs of security, the dimensions of the entrance in deterring predators. The entrance chamber is a mandatory feature as it allows owls to ingress and egress in safety. During the juvenile period, owls have the safety to get acclimated to their surrounding area as they peer out the restrictive opening but yet are able to scamper back to the safety of the rearing cavity. Hay or pine needles two inches in depth is needed as bedding on the floors of the hallway and rearing cavity.

As owls develop, the roominess of the rearing cavity allows flapping area for wing development and stimulates aggressive raptor characteristics. The air baffles that surround the outer house is a unique feature as it allows for air circulation during all seasons. This is important as it insures the least mortality rate of the young.

The perching poles are a necessity as it allows the young to develop strength of their wings and legs through vigorous exercise but yet are able to retreat back into the house until they have the confidence and development for their first critical flight.

The height of the barn owl box should be eleven to twelve feet above the ground, secured in place by a concrete foundation, a metal pole three inches in diameter insures no predators can scale. If an owl falls from the box, it can easily be returned for further rearing. This also allows for easy access for cleaning twice yearly through the back of the box. Fresh materials of hay or pine needles of two inches in depth should be replaced in the hallway and rearing cavity.

The nesting box must be of natural wood only. No paints, stains or metal materials should be used other than stated.

Construction Materials:

2 inch Wood screws (threaded)
2 Piano Hinges
1 Metal flag pole bracket
1 Metal pole 3 inches x 12 feet x 30in. (30in. in ground)
1/2 inch to 3/8 inch Marine plywood recommended

Wood glue
Cement
Wire mesh

1 Knob
2 Wood dowels 11/8 in.
2 x 4 in. Redwood
1/4 x 2 1/2 in. threaded metal bolts
1 1/2 in. redwood spacers (24)

Base Dimensions:

12 in. wide x 10 in. deep = 10 in. inside

[1] are locations for securing the floor to the base (2x4) with metal bolts

[2] are the locations for drilling 1/4 in. holes for mounting house to base (holes to be drilled when box is mounted on base to pole with lg. metal bolts)

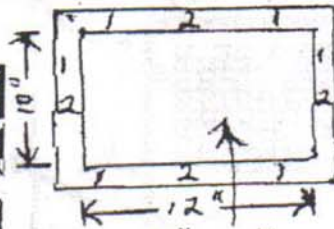

SAN JOAQUIN WILDLIFE RESCUE CENTER

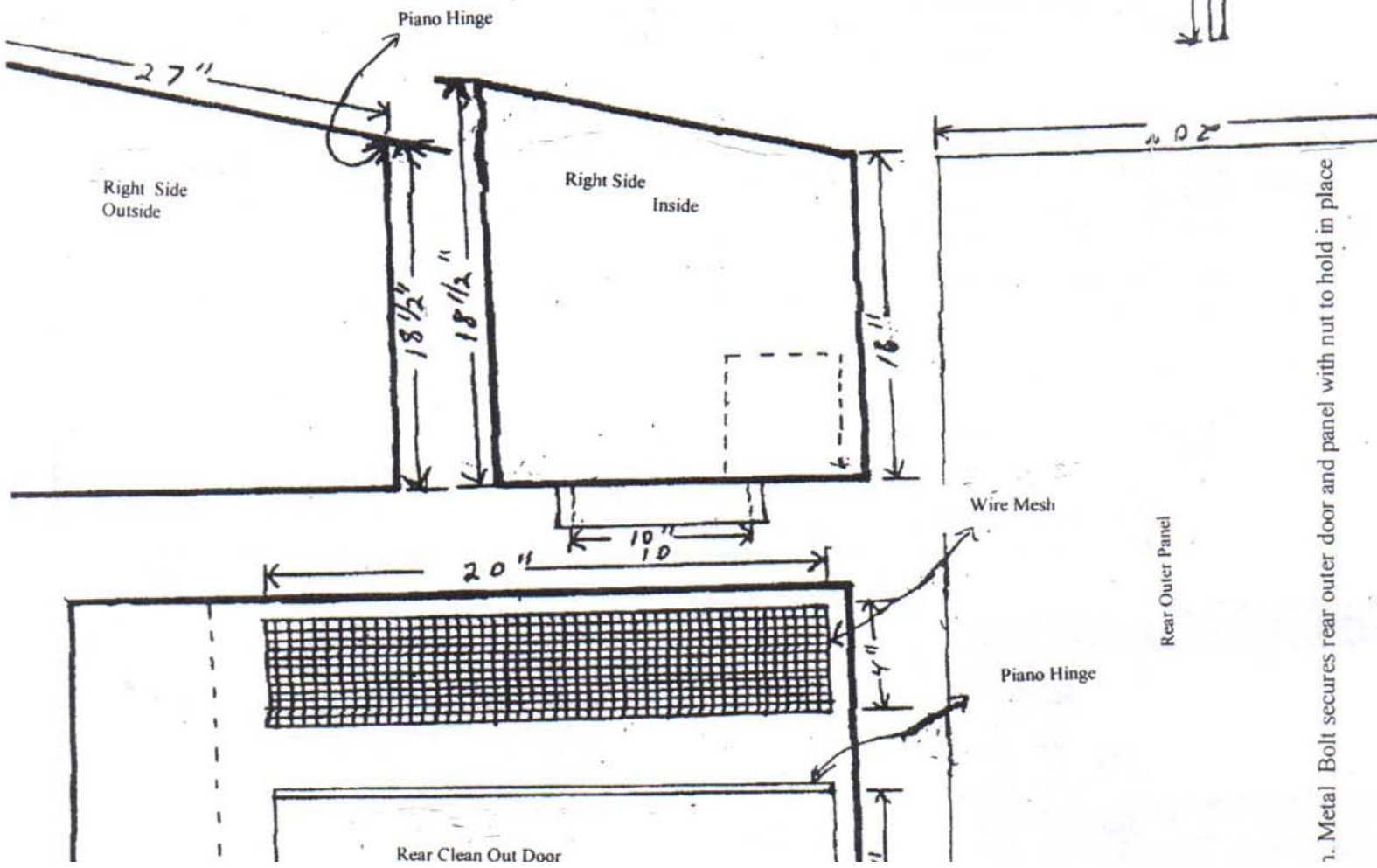
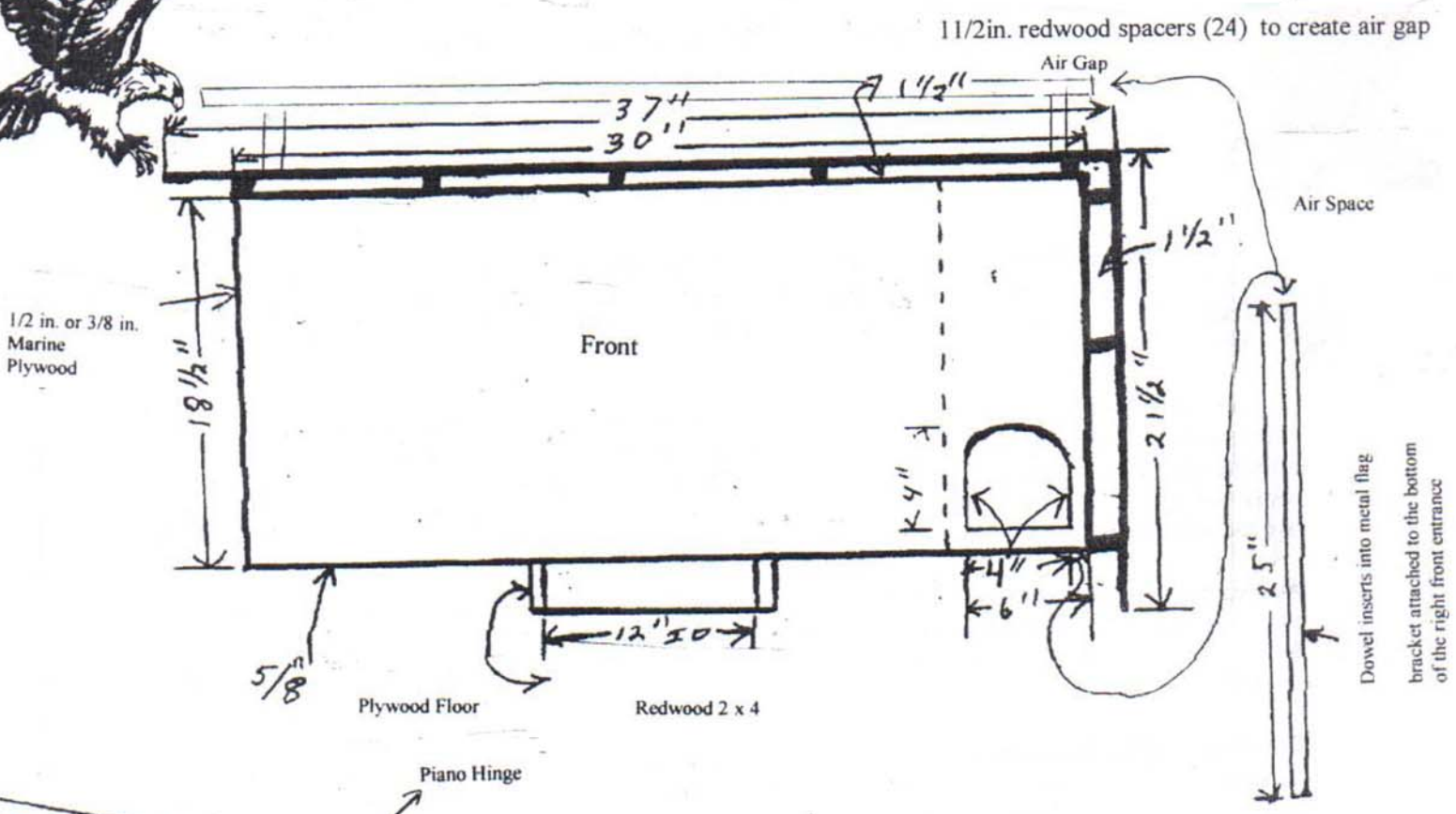

1. Metal Bolt secures rear outer door and panel with nut to hold in place